

Egbert Taylor

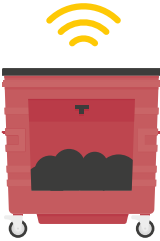

Products and Services





Egbert Taylor is the UK's leading provider of waste management solutions. We have over 50 years' experience in manufacturing four-wheeled metal waste containers including the award-winning Continental range. We deliver industry leading quality, which is why the 1.9m containers manufactured to date achieve an average life of 12 years in service. Egbert Taylor is a strong supporter of the local area, with over 90% of our raw materials and employees coming from within the local area. Being a British manufacturer and supporting other British businesses is something we are very proud of.

Our manufacturing site at Oak Park, Droitwich, continues to be our jewel in the crown and is at the very core of our business. Our manufacturing facilities, partners and knowledge of the waste industry is the driving force in our ability to service our customers' needs. Egbert Taylor has been on a remarkable journey since it first opened its doors in 1962 and we look forward to continuing that journey, supporting the local community and bringing best-in-class products and services to our loyal customers.

Brendan Murphy,
Impact Environmental Group



**The award winning
Taylor Continental 1100L**

Building on the past. Shaping the future.

All of our products are manufactured at our Oak Park site near Birmingham, England. We are certified to ISO 9001 and ISO 14001 (UKAS accredited), and we have been a proud Investor in People for over 30 years.

We supply over 90% of all UK local authorities and the main private sector contractors. Operating globally, we provide waste and recycling containment infrastructure for entire cities and countries.

Our products are designed to promote culture change and shape positive attitudes towards waste and recycling through engagement and communications.

We are positively changing public behaviour across the globe through our ability to reduce waste and help people improve recycling within their communities.

We represent the UK on the European Standards Committees for EN840, EN14803 and EN1501, and are a member of the Health & Safety Executive's Waste Industry Safety & Health (WISH) forum.



Contents

02	Introduction		16	Green Rewards	
06	Continental™ range		18	Greener refurbishment	
08	FM solutions		20	Spares & accessories	
10	Contamination prevention & T-Lock				
12	Node° & locking posts		24	Logistics	
14	Locking frames		26	EN840	

Bound by heritage. Driven by innovation.

With over five decades of shaping the global waste industry, we have evolved into a forward-thinking waste solutions provider representing multiple leading brands.

Behind every heritage story is an evolutionary path.

Our path:

- Has taken us from being a manufacturer of the globally renowned Taylor bins through to a waste solutions provider that harnesses the power of technology through multiple revolutionary brands
 - Has seen us not only evolve with, and respond to, changing industry demands, but also become pioneers within the waste sector
 - Will continue to see us create innovative solutions that meet the complex challenges of today whilst developing the waste technology solutions of tomorrow
- Reduce the operational cost of waste collection by increasing efficiency
 - Decrease the amount of movements and carbon emissions attributable to waste collection vehicles
 - Minimise health and safety risks associated with the movement of bins and collection vehicles
 - Provide municipalities, private companies and waste contractors with real-time access to the fill-level status of their entire bin fleet
 - Enable our customers to have a complete overview of the status of their waste assets
 - Produce historical information on bins that enable our customers to plan more efficient approaches to waste collection
 - Empower our customers, enabling them to make dynamic decisions in an ever changing environment



“In almost 50 years since joining the Egbert Taylor family, I’ve witnessed the business soar. From being a single-brand manufacturer, generating critical acclaim for its range of galvanised steel Taylor products, to a multi-solution manufacturer and waste solutions provider responsible for producing over 300 containers each and every day. I’ve seen huge change during this time, however one thing that has never changed is our ability to manufacture a world-class container that stands the test of time. Even now, I see our iconic 1100L bins coming back to the factory after 40 years of service only to be refurbished and given another lease of life.”

Tony Nunn, General Manager

Egbert Taylor evolution

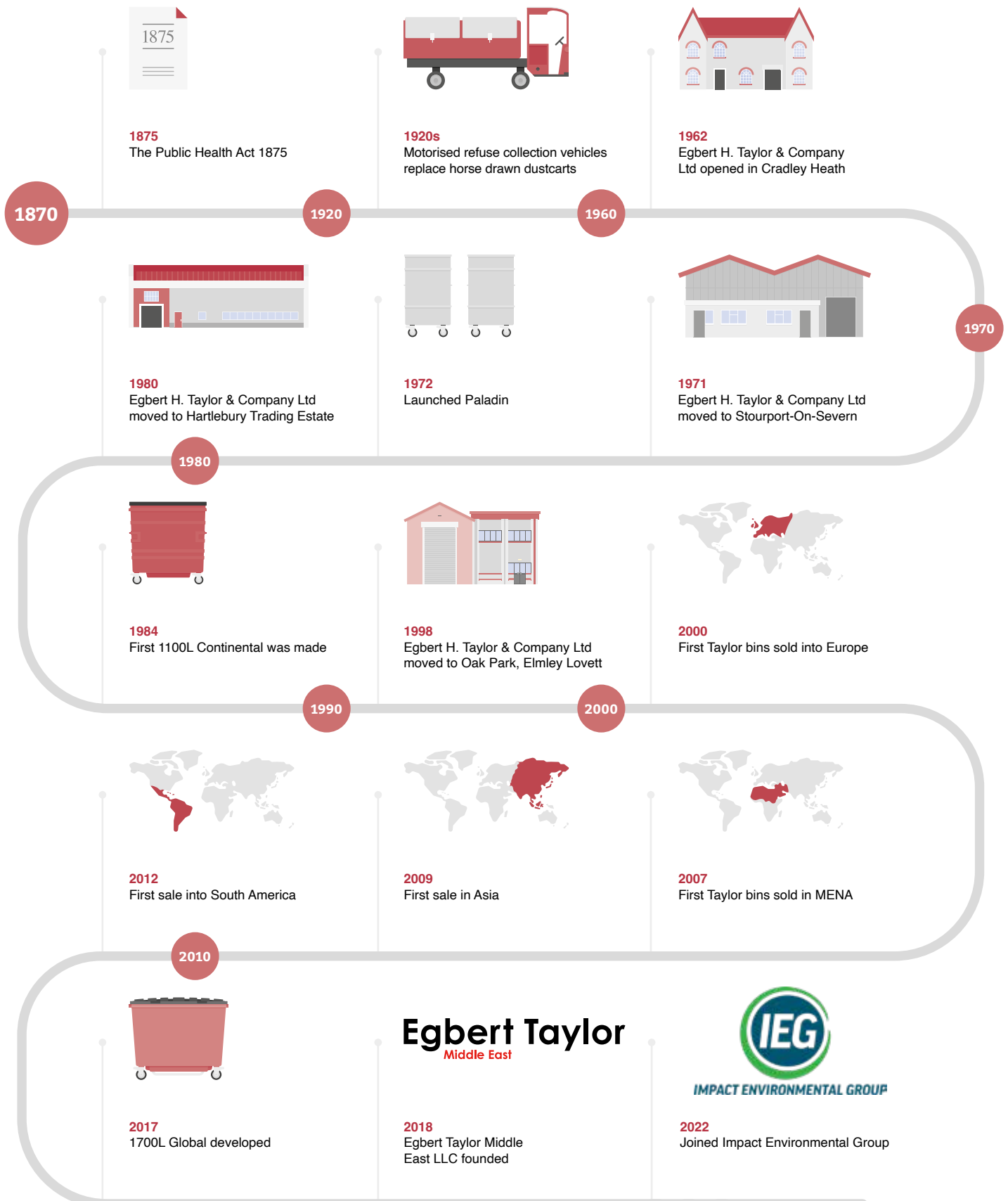

Taylor

Continental™ range

A rigid hot dip galvanised steel construction with internally welded seams means the Taylor Continental™ range, which is manufactured to EN840 standards at our UK plant, is built to last.



Continental™
1280L

Continental™
1100L

Trade

They not only provide a long and valuable service but offer fire containment and resilience to vandalism.

Led by our flagship 1100, the Continental™ range also includes the compact 500, 660, 700, 770, 820 and 1280 litre options to provide a solution for every waste containment requirement regardless of market sector.



Recycling

Our recycling range of Continental™ containers encourages the collection of the smallest recyclate up to the bulkiest cardboard collections, with a range of easy to use lids designed to engage the public in positive recycling behaviour.

Available in 500, 660, 700, 1100 and 1280 litre capacities.



Clinical UN approved

Taylor offers the largest range of UN approved clinical waste containers.

Our certified in-house testing facility, combined with our exceptional quality of manufacturing, which includes internally welded seams and a galvanised steel body with drop resistant castors, creates the ultimate container for clinical waste.





BUILT TO LAST, HERE TO STAY.



Continental™
820L



Continental™
770L



Continental™
700L



Continental™
660L



Continental™
500L

WEEE

The WEEE Bin has been adapted to cater directly for the collection and recycling of small to medium size electrical goods, and to divert small WEEE items from residual waste sent to landfill.

This specialist container allows for the simple collection and secure storage of unwanted electrical items. It also includes the



Uni-bin

Options include drop front and drop back, which have been created to help avoid the health and safety risks associated with handballing bagged or bulky waste. This is often an important requirement within retail and manufacturing environments.



Continental™ 500L food waste

The Continental™ 500 litre unit is built with quality in mind and is ideal for collecting heavy waste whilst maintaining safety. It offers over 10 years of proven performance, making it cheaper over the product's lifetime compared to plastic alternatives.

The 500 litre unit is ideal for dense waste, such as commercial food and glass. It is also available with fork lift pockets or a foot operated lid, and can be manufactured in a wide range of colours and feature other options.



Taylor

FM solutions

The Taylor Continental™ 1100L range has been adapted to provide our facilities management customers with waste containers that are easy to use and enhance productivity.

Drop front

Our Taylor Continental™ drop front containers have been created to help avoid the health and safety risks associated with handballing bagged or bulky waste, which is often an important requirement within retail and manufacturing environments.



Drop back

Our Taylor Continental™ drop back container, which features a front lift receiver (comb bar), has been created to help avoid the health and safety risks associated with handballing bagged or bulky waste, which is often an important requirement within retail and manufacturing environments.



Towing

Taylor Continental™ towing bins are more than just commercial waste bins with hooks and bars. Our towing containers are fully adapted and built with a heavy duty reinforced base. They include castors and a removable tow link system. The towing feature allows up to four wheeled containers at a time to be moved safely.





BUILT TO LAST, HERE TO STAY.

Internal fork

Adding fork pockets to your Taylor Continental™ containers allows for the safe and easy movement of containers around large sites. For operators with heavier waste requirements and access to forklift trucks, this simple enhancement can speed up waste transportation and allow for more effective waste collection points on site.



External Fork

Adding fork pockets to your Taylor Continental™ containers allows for the safe and easy movement of containers around large sites. For operators with heavier waste requirements and access to forklift trucks, this simple enhancement can speed up waste transportation and allow for more effective waste collection points on site.



“Taylors extensive range of products are ideally suited to FM providers on large sites. From fork pocket heavy duty to towing containers, our range makes us the perfect choice for those customers that are looking for a quality solution to waste management. Whatever the challenge, Taylor has a product to make the collection, movement and disposal of waste easier.”

Kevin Docherty, Area Business Manager



Taylor

Contamination prevention



seE-Bin

The Taylor 1100L seE-Bin successfully prevents the contamination of waste. The clear side panels allow easy identification of any unsegregated waste, therefore avoiding contamination of whole loads.



Cage

The mesh side panels of these 1100L recycling containers allow collection crews and users to become instantly aware of any incorrectly placed waste, preventing whole loads from becoming contaminated.



Lid in Lid

Taylor has created the Lid in Lid with waste segregation in mind. Located at the front of the bin and measuring 710mm x 360mm, the Lid in Lid's internal flap is lightweight and easy to open.



Restrictor Plate

Designed to control specific waste streams and enable segregation at source. Additional restrictor plates are available in a range of aperture shapes and sizes to control specific waste streams.



Restrictor Grid

The Restrictor Grid is great for converting a standard trade waste bin into an anti contamination bin. The grid allows for large quantities of recyclates to filter through whilst preventing general rubbish bags being put in the bin.



Reverse Lid

Prevent contamination and damage to logos with the Reverse Lid. The recycling aperture and logos are placed on the back of the bin, ensuring that the logos do not get damaged by RCVs and the locking mechanism is out of reach of the public.



Duo Bin

Ideal for customers without space for multiple containers, but who need to source segregate. Independently lockable lids either side of the Continental Duo Bin supports independent collection by a standard collection vehicle.



T-Lock

Simply turn the key to unlock the bin. Once emptied, press the lid down and it is locked. Specially developed as a robust alternative to the traditional cam lock and to keep the lid elevated when unlocked, so crews can clearly see that the bin is open.



BUILT TO LAST, HERE TO STAY.

T-Lock

The T-Lock has been successful in tackling many of the challenges created by using traditional triangular key locks.

A unique non triangular key, which has been designed so that only crews can access the main lid aperture, ensures the public cannot access the main container.

- Extremely effective in preventing the public forcing lids open
- Made from robust materials to ensure longevity of service
- Designed to work with Taylor's full range of lids as well as our Lid in Lid, which comprises a T-Lock in each corner for unrivalled security

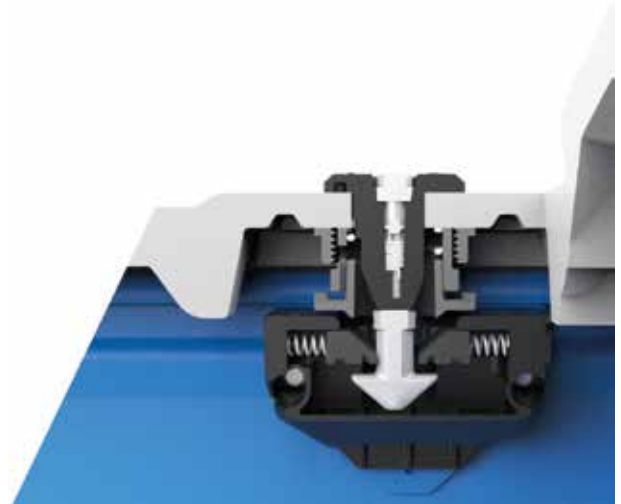

Benefits

- Sturdy and robust design
- Can be retrofitted
- Efficient operation
- Low maintenance

Features

- Push to lock system
- Reduces chances of contamination
- Unique key interface design
- Higher security against rough sleepers

Lid in Lid

Taylor has created the Lid in Lid (with optional restrictor plates) with waste segregation in mind. Additional restrictor plates are available in a range of aperture shapes and sizes to control specific waste streams. This enables waste segregation at source and prevents possible contamination.



Taylor

Node°

The Node° system offers a proven way to increase on street recycling participation in locations such as high and low rise flats where kerbside collections are not practical.

Through its distinctive appearance and ingenious design, the Node° mini-recycling centre attracts attention and offers a radical alternative to the conventional look of standard waste recycling bins.

Its modular system means that one to four units (Node 90°, Node 180°, Node 270° and Node 360°) can be configured to give a maximum 3,200 litres of capacity - all in a footprint smaller than a car parking space.

Technical

Capacity:	800L - 3200L
Empty Weight:	107kg (per segment)
Safe Lifting Weight:	320kg (per segment)

Features

- Pre galvanised sheet construction
- Internally seam welded
- EN12574 compliant
- Bolt on FEL pockets
- Rear handles
- Roto moulded double skin lid



Options

- Range of lid colour options
- Range of powder coated body colours
- Various lid apertures
- Ground base plate
- Locking options
- Fill level monitoring





BUILT TO LAST, HERE TO STAY.

Locking posts

The ultimate locking system has been designed to secure a Taylor Continental container. This system makes container storage secure and simple to use by operators with a locking catch mechanism.

Ideal for use in high-risk areas or where container theft is potentially a problem. An optional lid restraint bar restricts lid opening to avoid unwanted bulky waste. The locking post also protects units from damage attributable to severe weather conditions.

Both our four-wheeled and two-wheeled locking posts are made from fully welded hot-dip galvanised steel and include ground-mounted foot anchors for added security.

A specialist variant is also available for 360L and 240L domestic wheelie bins used in public spaces such as parks and lay-bys.

Technical

Compatibility: Taylor Continental range
500, 660, 770, 820, 1100, 1280L

Features

- Mild steel construction
- Pre-assembled
- On-site fitting available



Options

- Two or four wheeled
- Restrictor bar



Taylor

Two-wheeled locking frames

Taylor's two-wheeled bin frame allows operators, collectors and local authorities to secure single or multiple bins at designated locations. A modular design allows for expansion of the system to accommodate additional bin frames in the future.

With minimal groundworks, a single bin frame can be installed in approximately one hour. Each bin frame has a locking facility, which provides bin crews with easy access to the bin for emptying purposes. Each bin frame can accommodate signage, which can be customised to suit the client's requirements.

Technical

Capacity: 240L / 360L

Features

- Pre galvanised sheet construction
- Slam lock door



Options

- Range of logos
- Powder coating
- Freestanding base plate





BUILT TO LAST, HERE TO STAY.

Four-wheeled locking frames

Taylor's four-wheeled bin frames enable operators, collectors and local authorities to secure single and multiple bins at a designated location. This ensures the bins' security, prevents their unauthorised movement and provides a central location for community recycling. The frame design allows bin crews to efficiently gain access to the bin, empty it and quickly return it as the gate is fitted with a slam lock.

A modular design allows for expansion of the system sets to accommodate additional bins and bin frames in the future. With minimal groundworks, a single bin frame can be installed in approximately one hour.

Each bin frame has a locking access gate, through which bin crews can easily gain access to the bin for emptying purposes. Each additional bin frame can accommodate signage (on the rear panel and on the door), which can be customised to suit the client's requirements. This can be used to communicate recycling information and/or community information.



Technical

Capacity: 1100L / 1280L

Features

- Pre galvanised sheet construction
- Slam lock door

Options

- Range of logos
- Powder coating
- Freestanding base plate





Green Rewards

Egbert Taylor has introduced Green Rewards – a sustainability initiative that rewards local authorities for buying Taylor’s sustainably produced, UK made bins.



Each new build waste container is worth 400 points, each refurbished container is worth 200 points. 100 points is worth £1, with the incentive running for 12 months from the point of purchase. Points must be redeemed within six months of being awarded.

As part of the initiative, participating local authorities must agree to joint promotion of any initiative funded by Green Rewards. They are also expected to earn at least 10,000 points before qualifying for an Egbert Taylor-funded initiative. Points can be pooled with other local authorities in order to create joint initiatives, and all councils are entitled to use the fund as a credit against future purchases.

Finally, all participating local authorities must agree to Egbert Taylor approving where the funds will be allocated.



Driving CO₂ out of the supply chain

Taylor is continually investing in new ways to reduce its carbon footprint and to promote the use of metal containers in order to improve the environment.



Removing volatile organic compounds (VOCs) from manufacturing

Taylor products are more CO₂ and VOC friendly, and we wish to promote this by giving back to the community where our products are used on a daily basis.



Rewarding sustainable procurement

Taylor produces fully recyclable products in an environmentally friendly supply chain.



Supporting local environmental initiatives

Taylor wishes to contribute to local green initiatives such as school recycling campaigns, interactive food waste workshops or even tree planting.



Promoting 'Made in Britain' quality

Taylor is the only UK manufacturer of metal waste containers. Ours are 100% UK-sourced, 100% UK-welded and 100% British.





BUILT TO LAST, HERE TO STAY.

Collecting points

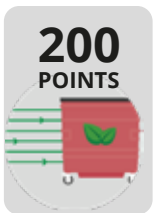

Taylor Refurbishment

- 100% VOC-free – Egbert Taylor does not use wet paint, which reduces all VOCs
- All refurbishments are powder coated, which means they have an 'as new' finish and are more durable
- All containers can be double stacked, which means twice as many containers can be transported in one delivery
- Every bin can be recycled when it reaches the end of its life

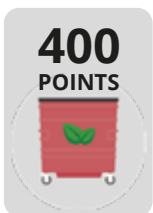

Taylor Continental

- Long life eco-friendly metal waste container
- UK suppliers – 90% of raw materials sourced within 25 miles
- UK steel – all steel is mined, furnaceed and pressed in the UK
- All container shells are manufactured in Droitwich using UK welders



Redemption process

Example 1. Over 12 months, a customer places an order for 20 new bins and receives 8,000 points. On their next order, they purchase 20 refurbished bins and receive 4,000 points. 12,000 points have been earned in total. The customer is entitled to £120, which can be used for a local initiative or a credit to be claimed against future orders.

Example 2. A customer places an order for 60 new bins and receives 24,000 points. Later on, the customer orders an additional 40 refurbishments and receives 8,000 points. 32,000 points are earned over these two orders. The customer is entitled to £320, which can be used for a local initiative or claimed as a credit against future orders.

Example 3. A customer places an order for 14 Bigbelly solar compactors and receives 28,000 points. The customer is entitled to £280, which can be used for a local initiative or claimed as a credit against future orders.

Taylor

Greener refurbishment



Egbert Taylor has developed its new Greener refurbishment programme in order to make our customers' bin and container fleet management as sustainable as possible – and all without compromising on quality.

From fire damage and dents to graffiti and structural damage, our team of skilled engineers can restore each unit to include standard Taylor castors, lids and logos, and provide a new, powder-coated finish. As part of the refurbishment programme, customers can convert their bins to include towing capability and a variety of lid designs and colours. For a cost effective and sustainable way in which to manage your bin fleet speak to a customer service advisor.



“As a business that refurbishes around 15,000 bins each year, our decision to adopt a production wide approach to powder coating not only lessens the environmental impact of each and every bin we refurbish, but also makes them look as good as new. As local authorities are now under pressure to make their bins last as long as possible, add value to the streetscene and achieve this in a sustainable manner, we believe that our decision to powder coat all bins, new and refurbished, addresses all three factors.”

Brendan Murphy,
Impact Environmental Group



BUILT TO LAST, HERE TO STAY.

Powder coating included as standard

We have now implemented carbon-free powder coating across all refurbished bins. Previously, powder coating was reserved for new bins only.

Using powder coating instead of wet paint prevents 600g of carbon per bin from being released into the atmosphere.



Driving CO₂ out of the supply chain



Removing volatile organic compounds (VOCs) from manufacturing

“

It's really important that we reduce the council's environmental impact wherever possible. By having access to powder-coated bins, we are now able to make even more sustainable choices when it comes to our waste collection provision. It's also important that our community can be proud of how their bins look and until now, the only way we could guarantee this was by purchasing new containers. However, the powder coated finish on Taylor's refurbished bins is exceptional and means that we can make our budgets work harder by extending the time between new purchases.”

MARC STEPHENSON - SERVICE MANAGER AT STOCKTON-ON-TEES BOROUGH COUNCIL

”

Benefits

- Powder coating cuts carbon emissions by 600g per bin compared with wet paint
- Get bins that look 100% new for 50% of the cost
- Superior finish, more durable, even coverage and no overspray

With our refurbishment programme, customers receive:

- A 10-point inspection of each bin submitted prior to them being returned
- Peace of mind that each unit has been restored by an in-house team of skilled Taylor engineers
- Reassurance that their newly refurbished units bear all the hallmarks of a genuine Taylor product for up to 40 per cent of the cost of a new container



Taylor

Spares & accessories

Castors

Our range of castors have been rigorously tested to comply with EN840 standards and to ensure they stand up to the stresses and strains of daily operational use. Their steel centres and rubber-tyred wheels ensure the smooth running of your containers.

Our complete range includes standard swivel through to heavy duty towing castors, and even includes non-marking castors that are suitable for internal environments.



Locks & lock accessories

Protect your investment with Taylor's range of replacement locks and lock accessories. If you've changed the usage of your container and need a different locking mechanism, or you just need new parts, then we can help you find what you are looking for.



RFID

Taylor containers are the only steel containers that are ready to accept our proprietary TagSafe technology. Fully EN14803 compliant and working with all chips, TagSafe holds the RFID chip and prevents the surrounding metal from diluting the RFID signal. We can factory fit TagSafe to all new and refurbished containers.



Towing

Taylor's unique removable link system for the Continental container range provides a safe and practical answer to all towing requirements. Taylor recommends that any container which is to be towed should be fitted with two fixed castors or two swivel castors, complete with directional locks, at one end of the container and that no more than four containers are towed at any one time.

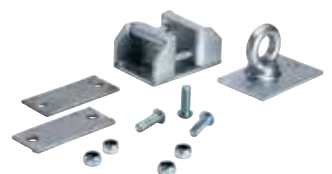



BUILT TO LAST, HERE TO STAY.

Lids

Taylor's range of robust double skinned, rotary moulded plastic lids are available in a wide variety of colours to suit your requirements. Whether you want your containers to stand out or blend in with their environment, we have a lid colour to suit. From standard black trade lids to orange flap recycling lids, we've got it covered. We also supply lids for other types and models of container.

Options

- Range of colours
- Range of types
- Range of lid apertures



Logo options

Effective use of a logo alongside an eye catching paint scheme is a key aspect in the design of a Taylor bin, and can convey a powerful brand image or message regarding container use.

Personalise your containers with a complete range of wrap logos or by adding a bespoke logo, available on most of our products and in two types: die-cut or digitally printed.

Our in-house design and print facility ensures that your logos are printed to our high standards and can meet your exact requirements.



Smart city solutions

Intelligent streets

Intelligent connected solutions increase operational efficiency and collect essential data points. These include:

- **Asset tracking**
Establish modern web-based asset tracking for both offline and connected assets such as bins and benches
- **Environmental sensors**
Detect changes within your local environment such as air and noise pollution, or climate tracking
- **Occupancy detection**
Gain detailed knowledge of occupancy from waste bins to toilets or buildings
- **Activity monitoring**
Accurately count traffic at a given urban or rural location, whether that be:
 - Pedestrian
 - Vehicle
 - Bicycle
- **Water management**
Detect early flood and drought warnings, and track water levels in reservoirs, canals, rivers and drains
- **Smart waste**
Fill level technology to create a data-driven solution across both domestic and commercial waste
 - Optional monitoring technologies: ultrasonic, laser & camera
 - Route optimisation
 - Navigation app
 - Management platform
 - Web browser, iOS & Android support

Forewarned is forearmed



Through fill-level monitoring and dynamic route management, Egbert Taylor's customers and partners now have 24/7 access to real-time data relating to their entire waste bin fleet.

Huntingdon installs smart litter bins

- Cambridgeshire-based Huntingdonshire district council converted more than a third of its litter bins into smart bins with fill level sensors supplied by Egbert Taylor
- Currently, there are over 350 sensor-equipped litter bins in place following a trial, which saw collections reduced from what would have been 13,200 to 9,651 between 22 May – 31 December 2020. Now, on average, every bin is emptied every three days instead of every day, five days a week
- The council achieved a reduction in collections of 27% without requiring any additional capacity



“With the addition of these sensors it enables our teams to be more efficient on collection days, knowing exactly where they need to be, and which bins require emptying. It allows us to provide a greater service for residents as we can adjust our focus accordingly and have a greater and more targeted impact with our efforts. The council is always looking for ways to improve our services and small changes such as these sensors provide a huge and positive change to street cleansing across Huntingdonshire.”

Marge Beutell, Executive Councillor for Operations and Environment

Logistics

Driven by innovation, delivered by experience

Egbert Taylor has been delivering in the UK since day one. In this time, we have developed strong relationships with a network of partners who specialise in delivering our products across the globe.

We understand that a large portion of costs can be due to the shipping of a product. Therefore, we have ensured that the shipping of our products are as cost effective as possible by:

- Improving stacking densities to create efficiencies
- Designing products to maximise transportation
- Providing assembly at the customer's destination
- Investing in vehicles to increase transport capacity by over 80%





Why Taylor?

In the waste industry, there are nine times more fatal accidents and four times more injuries than the UK average. Therefore, we are committed to ensuring that all of our four-wheeled and two-wheeled bins are EN840 compliant for the safety of waste workers and the general public.

Comb bar

Constructed so that it fits on an approved, compatible lifting device and automatically locates and locks safely into the lifting device during the lifting operation. EN840 parts 2 and 5.



2mm thick rolled steel section with step profile for safe and efficient integration on vehicle lifts (recognised design). Manufactured from a single piece of folded steel with gussets for strength. Compliant with EN840 part 2, which works with the EN1501 RCV to ensure that compliant vehicles and bins can be safely used together.

Castors

Castors must pass five vigorous EN840 tests including pull, brake and kerb impact in order to be accredited.



Our metal castors have evolved over years of testing. We work alongside our suppliers to ensure that all components work in harmony with one another and are EN840 compliant. EN840 part 5. We can provide all individual test reports upon request.

Handles

Handles must conform to EN840 clearance and space restriction to ensure safety of the operator when moving the bin. EN840 part 6.



All Taylor handles comply with dimensions laid out by EN840. Clearance, form and layout of handles are carefully considered to ensure safety and ease of operating. EN840 parts 2, 5 and 6.

Construction

Designed to retain integrity of the bin and add rigidity to the overall shape.



Patented tubular 20mm top frame. Pressing in front steel panel to add strength to prevent distortion.



Inferior material found on competitor bins are prone to premature fatigue of the lifting points. The comb bar is the most important part of a bin as it is responsible for lifting the weight of a full bin in the air.

Any failures could result in serious injury or fatalities.



Inferior castors will not feature the low rolling resistance which contributes to injury. The components will fail prematurely rendering the container inoperable.



Non-compliant handles are made of material that is substandard. Many handles aren't ergonomically designed therefore can lead to further injury.



Other manufacturers use 16mm top frame. Distortion of the top frame can affect integrity of the comb lifting bar.

Setting the standards

EN840 is the recognised European standard for both two and four-wheeled containers of varying capacities and specifications. Containers from 500 to 1300 litres conform to EN840 standards 2, 5 and 6.

Requirements for EN840 in relation to four-wheeled bins include but are not limited to:

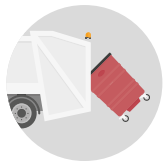

Bins must be compatible with lifting devices

All Taylor bins are designed to be compatible with EN1501-5 compliant lifting devices. Bins are lifted with their maximum load 100 times and tested for signs of deformation and safe integration.



Castors must withstand a third of maximum weight

Taylor has developed its own specification for castors, which exceeds the requirements of EN840. Using high quality materials and construction techniques, they are some of the strongest castors available.

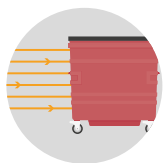

Containers must pass the 10 physical tests specified within EN840

Taylor operates its own R&D facility to promote continual quality improvements.



Lifting handles

Lifting handles must be strong enough to avoid damage caused by collisions or from disconnecting when used to lift the container up a kerb.





The 10 physical tests include:

1. Impact test by ball drop

Must withstand impact from 5kg weight from 0.8m height

2. Impacts on an inclined plane + kerb travel (run) impact

Impact testing various sides of the test loaded container at 1.85m/s against a solid wall

3. Kerb travel (falls) drop

Test loaded container lifted to kerb height and dropped a minimum of 1,000 times

4. Stability test

Stability of test loaded container is tested by parking in three positions on a 10 degree slope and the castor brakes applied. Container must not tip or slide down the slope

5. Pulling and rolling resistance

Maximum 300Nm pulling force to begin moving test load container, 285Nm to pull once moving a minimum of 3m

6. Wheels testing

Radial castor test covering a 20km rolling distance at a minimum of 3.3km/h

7. Lifting-tilting test

Test loaded container lifted for a minimum of 100 lifting cycles on EN1501 certified lifting equipment

8. Kerb handle strength test

Test loaded container handle lifted a minimum of 50mm high, five times per minute for a minimum of 1,000 cycles

9. Volume testing

Double-tank method used to confirm capacity is within 5% tolerance specified in standard

10. Brake testing

Test loaded container is tested by parking in a lateral position on a 10 degree slope and the castor brakes applied

“For over five decades we’ve worked extremely hard to design and manufacture containers that meet the needs of our customers across the world. Our research and development team continues to invest heavily in on-going product development, improvement and innovation.

In fact, our own in-house testing facility, which enables us to guarantee that all our four-wheeled and two-wheeled bins are EN840 compliant, completely differentiates us from any other UK-based manufacturer of galvanised steel containers.

Egbert Taylor’s expertise and technical knowledge has enabled us to carve a reputation for ‘quality-without-compromise’ and it’s this message that is now attracting customers from around the world, most of which place quality above everything else.

Research and development has always been and will continue to be the lifeblood of Egbert Taylor, not just in the UK but also internationally.”

Jamie Roberts, Technical Engineering Manager



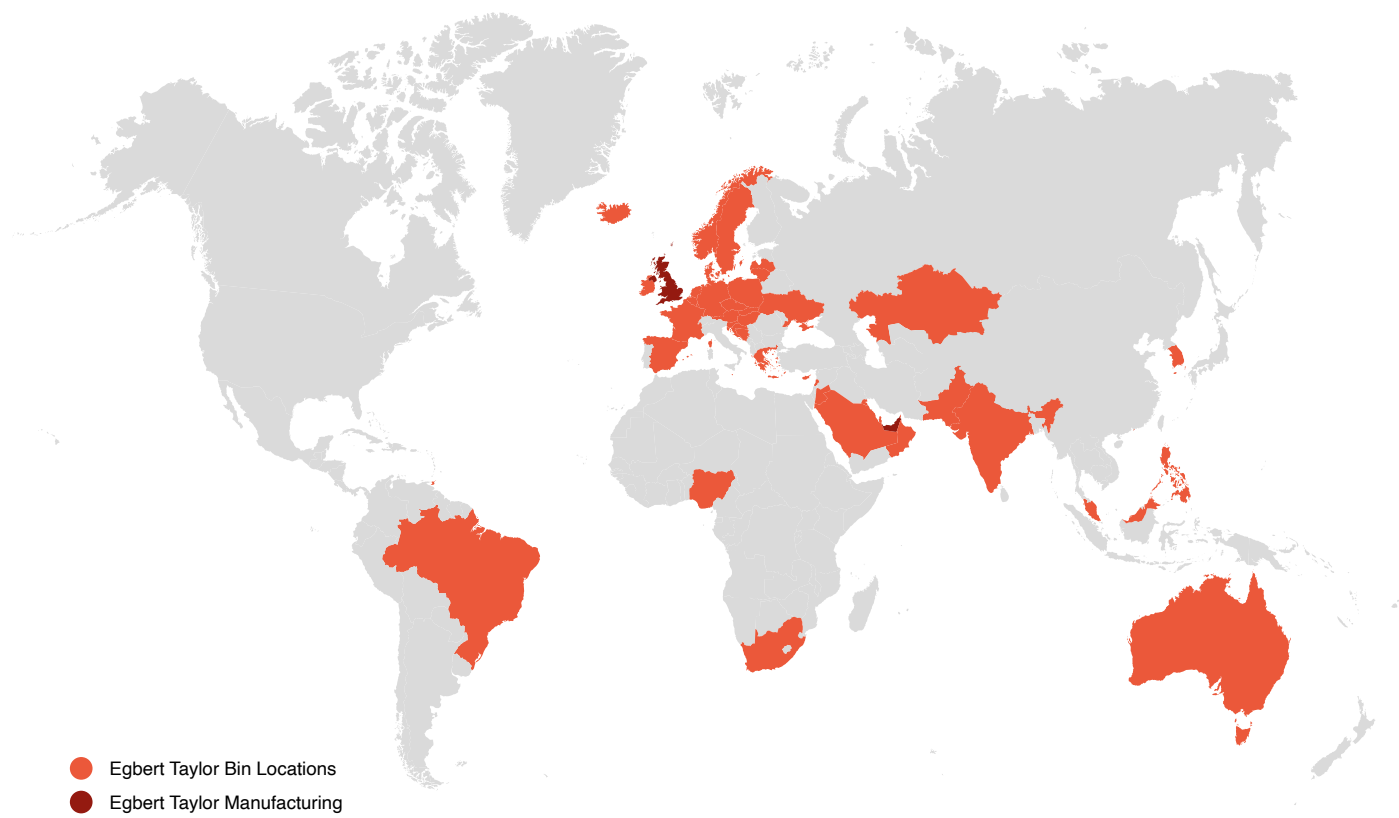

- Egbert Taylor Bin Locations
- Egbert Taylor Manufacturing



United Kingdom
e: info@egberttaylor.com
t: 01299 251 333



Europe
e: export@egberttaylor.com
t: +44 1299 251 333



Egbert H. Taylor & Co Ltd
Oak Park,
Ryelands Lane,
Elmley Lovett,
Droitwich,
WR9 0QZ.
United Kingdom

t: +44 (0)1299 251 333
e: info@egberttaylor.com
w: egberttaylor.com



IMPACT ENVIRONMENTAL GROUP